

HFV8

SUBMINIATURE AUTOMOTIVE RELAY



Typical Applications

Fuel pump control, Fan control, Fog lamp & headlight control, A/C compressor clutch, Horn control

Features

- Switching capacity up to 40A
- SPST-NO & SPDT contact arrangement
- 2.8mm plug-in terminals
- Ambient temp. up to 125°C
- Sealed IP67 or dust cover types

CONTACT DATA

Contact Arrangement	1A, 1C
Max . Switching Current	40A
Max . Switching Voltage	75VDC
Max . Switching Power	560W
Max. Continuous Current	40A(23°C) 30A(85°C)
Contact Rating	1A (1 Form A):40A 14VDC 1C (1 Form C): NO/NC 40A/ 30A 14VDC
Contact Material	AgSnO ₂
Initial Contact Resistance	100 mΩ (at 1A 6VDC)
Electrical life	1X10 ⁵ OPS
Mechanical life	1X10 ⁷ OPS

CHARACTERISTICS

Initial Insulation Resistance	500MΩ 500VDC
Dielectric Strength	500VAC, 1 min
Operate time (at nom. Vol.)	Max. 10 ms
Release time (at nom. Vol.)	Max. 6 ms
Ambient Temperature	- 40°C to +125°C
Shock resistance	200 m/s ²
Vibration resistance	1.27mm, 10 ~ 40Hz; 40 ~70Hz 50m/s ² 0.5mm, 70 ~ 100Hz; 100 ~500Hz 100m/s ²
Termination	ISO
Unit weight	Approx. 22g or 37g (waterproof form)
Construction	Sealed IP67 & Dust cover

COIL

Coil power	1.32 W / 1.53W (parallel resistor)
Coil voltage	6VDC, 12VDC, 24VDC

COIL DATA

Standard Type

Coil Voltage (VDC)	Coil Resistance (Ω)	Must-Operate Voltage (VDC)	Must-Release Voltage (VDC)	Allowable Overdrive (VDC)	
				@23°C	@85°C
006	27± 10%	3.6	0.6	10	7.8
012	109± 10%	7.2	1.2	20.2	15.7
024	436± 10%	14.4	2.4	39.3	28.6



HONGFA RELAY
ISO9001、ISO/TS16949、ISO14001 CERTIFIED

VERSION: EN02-20040601

ORDERING INFORMATION

		HFV8 /		012	1H	1	S	R	XXX
Type									
Coil voltage		6,12,24VDC							
Contact arrangement		1H: 1 Form A 1Z: 1 Form C							
Version		1: Standard 2: Waterproof cover							
Structure		S: Sealed IP67 Nil: Dust cover							
Parallel resistor		R: With resistor (6V -180 Ω, 12V-680 Ω, 24V-2700 Ω) D: Parallel diode (D1:anode on #86, D2:anode on #85) Nil: Without resistor							
Customer special request code:									

OUTLINE DIMENSIONS, WIRING DIAGRAM AND PC BOARD LAYOUT

HFV8/XXX-1X1

Outline Dimensions

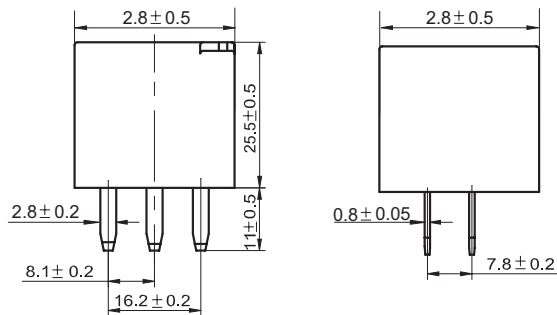

PC Board Layout

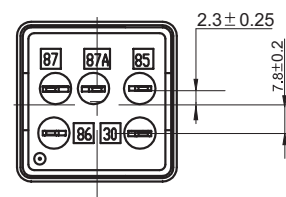

HFV8/XXX-1X2

Outline Dimensions

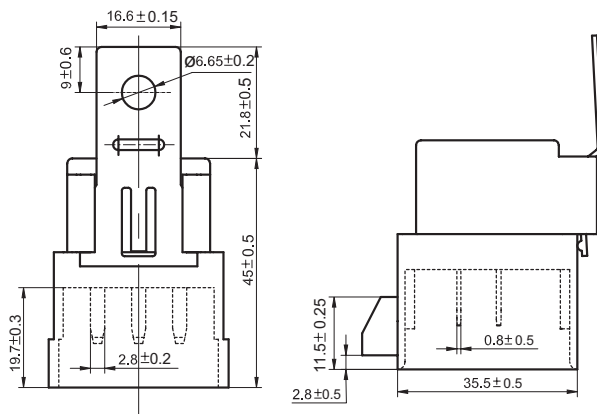

PC Board Layout

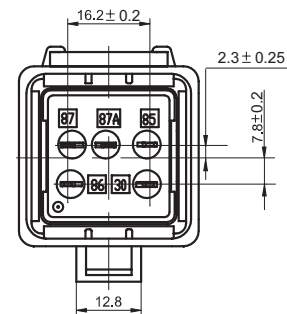

Wiring Diagram

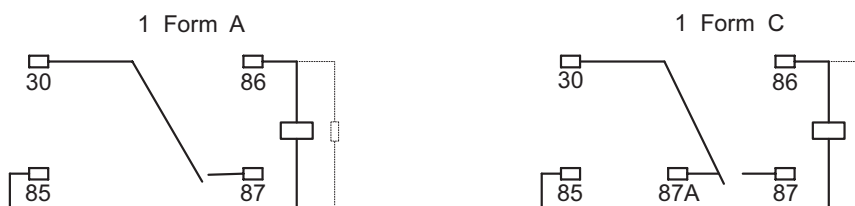

CHARACTERISTICS CURVE

Ambient Temperature VS. Coil voltage(%Un)

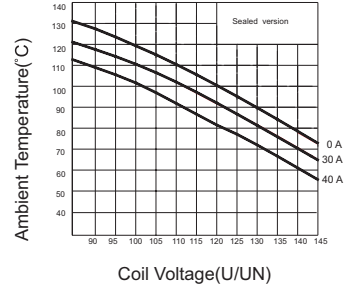
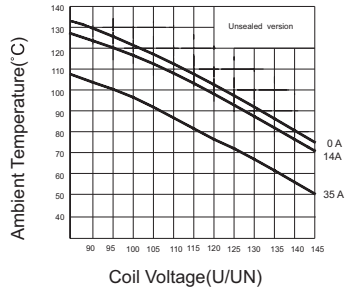

Limiting Curve for Power Load

